

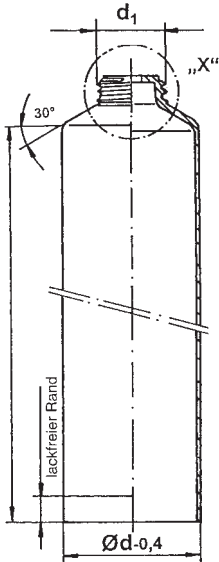

## Technical Data PLASTIC TUBES

cylindrical in accordance  
with DIN EN 13045, DIN 5059/2  
and TUBEX Production Standard



Thread - versions

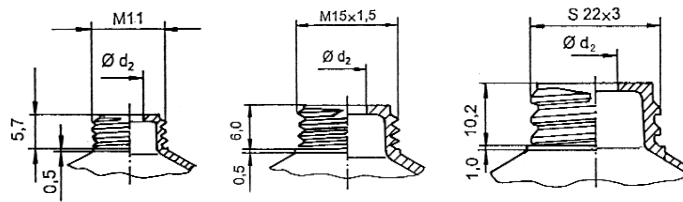

push-on version

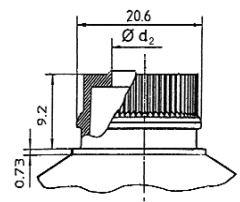

shapes of available tube heads

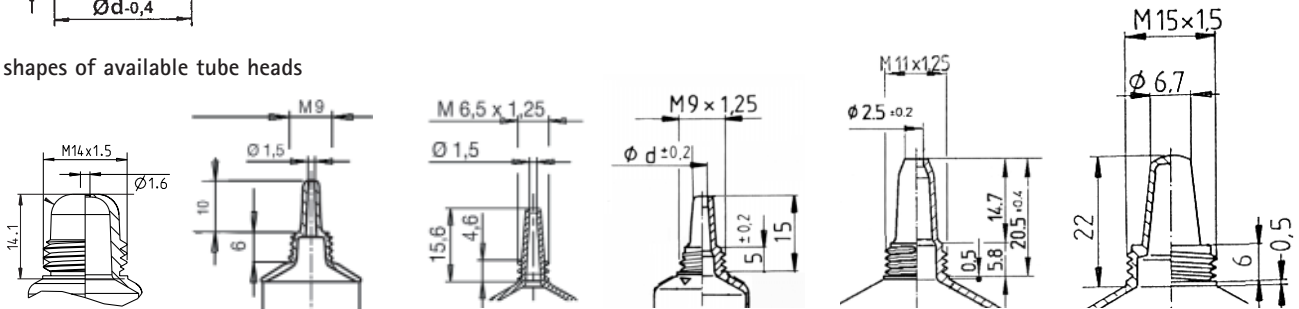

### MATERIAL:

PE-HD (high density polyethylene), PE-LD (low density polyethylene), copolymer, co-extruded tube with or without EVOH barrier layer.

### MANUFACTURING PROCESS:

Tube shoulder is welded to the seamlessly extruded tube body.

### SPECIAL DESIGN:

Coex-Tube with specific barrier properties, special haptic and visual effects. Highly transparent tubes, tubes with UV-protection. Tamper evident seal out of aluminium and plastic. Special neck finish for pushed on caps.

### DECORATION:

Clear, white or coloured finish of tube body and shoulder. Rotary offset printing up to 7 colours in addition to the colour of the tube body. Screen print, high definition of print by laser cut plates. Gold, silver and coloured foil blocking, 6 colours silkscreen print. Clear varnish in mat or gloss finish in order to protect inks and to reduce permeability of tube body. Labelling.

### CAPS:

Screw caps, Flip-top caps screwed on or pushed on, orientated to print.

Nominal diameter d	Max. length l	Thread/push-on-version d <sub>1</sub>	Orifice d <sub>2</sub> ± 0,2
19	120	M11	1,5 - 5,5
22	150	M11	1,5 - 5,5
25	160	M11	1,5 - 5,5
30	180	M15	1,5 - 9,0
35	190	M15	1,5 - 9,0
		20,6	10
40	190	M15	1,5 - 9,0
		20,6	10
		S22x3	1,5 - 15
50	200	S22x3	1,5 - 15
		TR 23x2,5	1,5 - 17,5
		20,6	10 + 14

### Tube heads

Nominal diameter d	Thread d <sub>1</sub>	Type	Orifice ± 0,2
19	M 6,5	elongated nozzle	1,5
	M 9	elongated nozzle	1+2
	M 14	spherical head	1,6
30	M 11	elongated nozzle	2,5
50	M 15	elongated nozzle	closed

Technical Data  
**Filling Contents for  
 PLASTIC TUBES**



Volume	Diameter in mm						
	19	22	25	30	35	40	50
10 ml	60						
15 ml	80	65					
20 ml	100	80	70				
25 ml		95	80				
30 ml		110	95	80			
40 ml			115	95			
50 ml				110	90		
60 ml				125	100		
75 ml				140	115	105	
80 ml					125	110	
100 ml					150	125	110
125 ml					175	145	115
150 ml						165	130
200 ml							160
250 ml							185
275 ml							200
min. Length	50	50	70	70	70	70	85
max. Length	120	150	160	180	190	190	200

Areas with white background represent the recommended tube length.

**PRODUCTION SITES:**

TUBEX GmbH  
 Fabrikstraße 1  
 72414 Rangendingen  
 GERMANY

Fon: +49 (0) 7471 990-0  
 Fax: +49 (0) 7471 990-523  
 info@tubex.de  
 www.tubex.de

TUBEX Plastic Ltd.  
 Gortlandroe Industrial Estate  
 Nenagh, Co. Tipperary  
 IRELAND

Fon: +353 (0) 67 44932  
 Fax: +353 (0) 67 33862  
 bsmyth@tubex.ie